

METRIC PLAIN EYE BOLT

316-NM STAINLESS STEEL

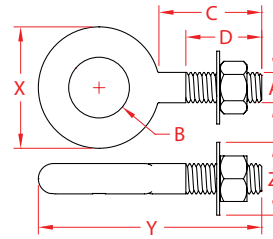

ITEM	A (size)	B	C	D	X (height)	Y (length)	Z (width)	WLL (lb)	WT (lb)	PACKAGING TYPE	EACH (qty)	INNER (qty)	CARTON (qty)	UPC
S0315-0705M	M6	0.50"	2.00"	1.50"	1.03"	3.08"	0.46"	500	0.06	POLYBAG	1	10	200	791506040521
S0315-0710M	M6	0.50"	4.00"	2.50"	1.03"	5.07"	0.46"	500	0.08	POLYBAG	1	10	200	791506040545
S0315-0803M	M8	0.63"	1.38"	0.38"	1.18"	2.57"	0.61"	800	0.08	POLYBAG	1	10	100	791506040552
S0315-0806M	M8	0.63"	2.25"	1.50"	1.18"	3.50"	0.61"	800	0.09	POLYBAG	1	10	100	791506040576
S0315-0810M	M8	0.63"	4.25"	2.50"	1.18"	5.50"	0.61"	800	0.14	POLYBAG	1	10	100	791506040590
S0315-1002M	M10	0.75"	0.75"	0.75"	1.50"	2.35"	0.76"	1,200	0.16	POLYBAG	1	10	100	791506040613
S0315-1003M	M10	0.75"	1.50"	1.00"	1.50"	3.07"	0.76"	1,200	0.18	POLYBAG	1	10	100	791506040620
S0315-1006M	M10	0.75"	2.50"	1.50"	1.50"	4.10"	0.76"	1,200	0.21	POLYBAG	1	10	100	791506040644
S0315-1012M	M10	0.75"	4.50"	2.50"	1.50"	6.05"	0.76"	1,200	0.27	POLYBAG	1	10	100	791506040668
S0315-1304M	M12	1.00"	1.50"	1.00"	2.02"	3.65"	0.93"	2,150	0.37	POLYBAG	1	1	50	791506040682
S0315-1308M	M12	1.00"	3.25"	1.50"	2.02"	5.40"	0.93"	2,150	0.48	POLYBAG	1	1	50	791506040705
S0315-1315M	M12	1.00"	6.00"	3.00"	2.02"	8.20"	0.93"	2,150	0.59	POLYBAG	1	1	50	791506040729
S0315-1603M	M16	1.25"	1.00"	0.75"	2.52"	3.60"	1.17"	3,440	0.70	POLYBAG	1	1	50	791506040743
S0315-1605M	M16	1.25"	2.00"	1.75"	2.52"	4.65"	1.17"	3,440	0.76	POLYBAG	1	1	50	791506040767
S0315-1610M	M16	1.25"	4.00"	2.00"	2.52"	6.60"	1.17"	3,440	0.93	POLYBAG	1	1	25	791506040781
S0315-1615M	M16	1.25"	6.00"	3.00"	2.52"	8.60"	1.17"	3,440	1.11	POLYBAG	1	1	25	791506040804
S0315-2003M	M18	1.50"	1.00"	1.00"	2.90"	4.00"	1.32	5,140	0.94	POLYBAG	1	1	10	791506040828
S0315-2005M	M18	1.50"	2.00"	1.75"	2.90"	4.98"	1.33"	5,140	1.05	POLYBAG	1	1	10	791506040842
S0315-2012M	M18	1.50"	4.50"	2.00"	2.90"	7.50"	1.33"	5,140	1.31	POLYBAG	1	1	10	791506040866
S0315-2015M	M18	1.50"	6.00"	3.00"	2.90"	8.90"	1.33"	5,140	1.52	POLYBAG	1	1	10	791506040880
S0315-2213M	M20	1.75"	5.00"	2.50"	3.40"	8.55"	1.50"	7,130	2.02	POLYBAG	1	1	15	791506040903
S0315-2504M	M24	2.00"	1.38"	1.38"	4.00"	5.75"	1.72"	9,370	2.75	POLYBAG	1	1	5	791506040927
S0315-2506M	M24	2.00"	2.50"	2.25"	4.00"	7.00"	1.72"	9,370	2.92	POLYBAG	1	1	5	791506040941
S0315-2515M	M24	2.00"	6.00"	3.00"	4.00"	10.25"	1.72"	9,370	3.73	POLYBAG	1	1	5	791506040965

NOTE:
MEETS ASME B30.26-2010 SECTION 26-2.0. EYE BOLTS HAVE FORGED MARKINGS OF 316-NM, SIZE AND WLL IN TONS. ALL THREADS ARE METRIC. ONE NUT AND WASHER ARE INCLUDED. EXTRA NUTS AND WASHERS ARE AVAILABLE FROM STOCK. SHAFT IS MACHINED FOR PERFECT FIT AND SEATING. ALL DIMENSIONS ARE NOMINAL (+/- 3%) AND ARE SUBJECT TO CHANGE WITHOUT NOTICE.